

Each combination includes 1 Nexus starter frame and 1 adder frame at the height shown. Combinations designated with "SM" surface mount to a Lista or other workbench with a work-surface at least 6" longer than the Nexus frames. Combinations designated with "RM" rear mount to a Lista Align® adjustable height base only. Certain combinations are available with optional overhead lights (see charts below illustrations for availability).

## How to order an Easy-Order Nexus Accessory Combination

### 1. Select Easy-Order Nexus Accessory configuration.

### 2. ■ Select worksurface length.

**60** = 60" long (combination consists of 24" wide starter frame and 30" wide adder frame)

**72** = 72" long (combination consists of 30" wide starter frame and 36" wide adder frame)

### 3. □ Select paint color. For color chart, see back cover or below.

### 4. ■ Select lock type for models with overhead cabinets included.

**RG** = individual  
**KA** = keyed-alike  
**MA** = master

**EXAMPLE:** to order an NXC/SM4827 Nexus combination to install on a 72" long worksurface, with Bright Blue paint and keyed-alike locks for the overhead cabinets, the part number would be **NXC/SM4827-72BBKA**.

## 30" High Nexus Frames

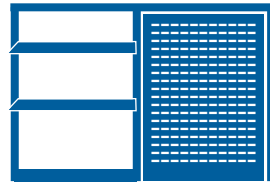

Includes:

- (2) 12" deep shelves
- (1) back stop
- (1) 30" high louvered panel

PART NO.	DESCRIPTION
NXC/SM3001-■□	surface-mount

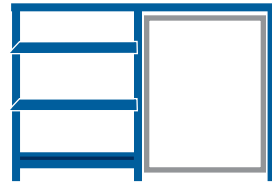

Includes:

- (2) 12" deep shelves
- (1) plastic box rail
- (1) 30" high markerboard/tackboard
- (1) vertical power strip

PART NO.	DESCRIPTION
NXC/SM3002-■□	surface-mount

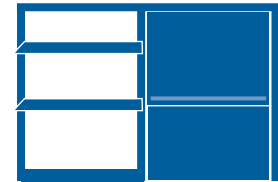

Includes:

- (2) 12" deep shelves
- (1) back stop
- (1) 18" high solid privacy panel
- (1) 16" high overhead cabinet with retractable door

PART NO.	DESCRIPTION
NXC/SM3023-■□■	surface-mount

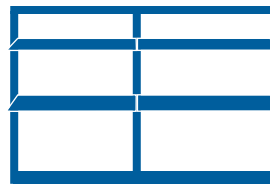

Includes:

- (2) 12" deep shelves
- (2) 15" deep shelves
- (2) back stops

PART NO.	DESCRIPTION
NXC/SM3005-■□	surface-mount

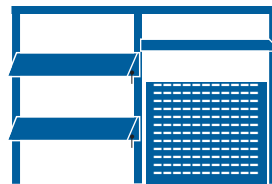

Includes:

- (2) 18" deep variable angle shelves
- (1) 12" deep shelf
- (1) 18" high louvered panel

PART NO.	DESCRIPTION
NXC/SM3006-■□	surface-mount

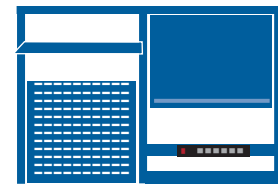

Includes:

- (1) 12" deep shelf
- (1) 18" high louvered panel
- (1) 16" high overhead cabinet with retractable door
- (1) horizontal power rail
- (1) back stop

PART NO.	DESCRIPTION
NXC/SM3024-■□■	surface-mount

**Custom Products & Services, Inc.**

6140 Claude Way E.,  
 Inver Grove Hts., MN. 55076  
 PH: 888-444-1202 FAX: 651-452-2264  
 E-Mail: info@custom-products.com  
 Website: www.custom-products.com

## 48" High Nexus Frames

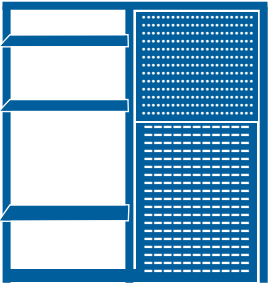

Includes:

- (2) 12" deep shelves
- (1) 15" deep shelf
- (1) back stop
- (1) 18" high pegboard panel
- (1) 30" high louvered panel

PART NO.	DESCRIPTION
NXC/SM4801- <span style="color:red">■</span> <input type="checkbox"/>	surface-mount
NXC/SM4811- <span style="color:red">■</span> <input type="checkbox"/>	surface-mount with 56" 4-bulb overhead light
NXC/RM4801- <span style="color:red">■</span> <input type="checkbox"/>	rear-mount for Align base
NXC/RM4811- <span style="color:red">■</span> <input type="checkbox"/>	rear-mount for Align base with 56" 4-bulb overhead light

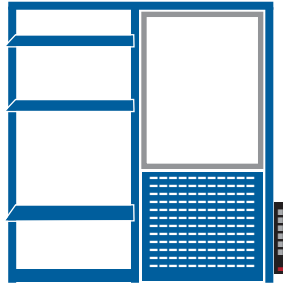

Includes:

- (2) 12" deep shelves
- (1) 15" deep shelf
- (1) back stop
- (1) 30" high markerboard/tackboard
- (1) 18" high louvered panel
- (1) vertical power strip

PART NO.	DESCRIPTION
NXC/SM4802- <span style="color:red">■</span> <input type="checkbox"/>	surface-mount
NXC/SM4812- <span style="color:red">■</span> <input type="checkbox"/>	surface-mount with 56" 4-bulb overhead light
NXC/RM4802- <span style="color:red">■</span> <input type="checkbox"/>	rear-mount for Align base
NXC/RM4812- <span style="color:red">■</span> <input type="checkbox"/>	rear-mount for Align base with 56" 4-bulb overhead light

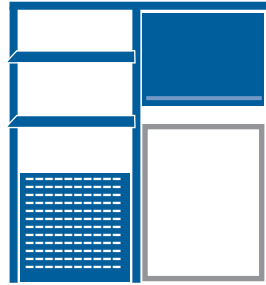

Includes:

- (2) 12" deep shelves
- (1) 18" high louvered panel
- (1) 16" high overhead cabinet with retractable door
- (1) 30" high markerboard/tackboard

PART NO.	DESCRIPTION
NXC/SM4823- <span style="color:red">■</span> <input type="checkbox"/>	surface-mount
NXC/RM4823- <span style="color:red">■</span> <input type="checkbox"/>	rear-mount for Align base

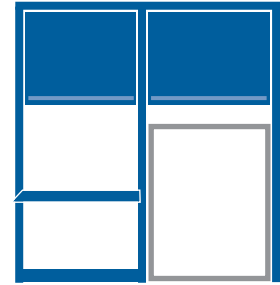

Includes:

- (2) 16" high overhead cabinets with retractable doors
- (1) 12" deep shelf
- (1) back stop
- (1) 30" high markerboard/tackboard

PART NO.	DESCRIPTION
NXC/SM4827- <span style="color:red">■</span> <input type="checkbox"/>	surface-mount
NXC/RM4827- <span style="color:red">■</span> <input type="checkbox"/>	rear-mount for Align base

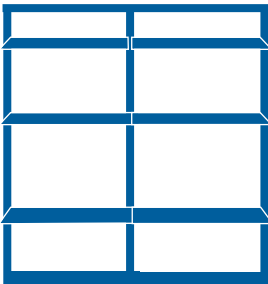

Includes:

- (4) 12" deep shelves
- (2) 15" deep shelves
- (2) back stops

PART NO.	DESCRIPTION
NXC/SM4804- <span style="color:red">■</span> <input type="checkbox"/>	surface-mount
NXC/SM4814- <span style="color:red">■</span> <input type="checkbox"/>	surface-mount with 56" 4-bulb overhead light
NXC/RM4804- <span style="color:red">■</span> <input type="checkbox"/>	rear-mount for Align base
NXC/RM4814- <span style="color:red">■</span> <input type="checkbox"/>	rear-mount for Align base with 56" 4-bulb overhead light

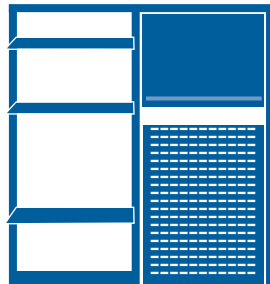

Includes:

- (2) 12" deep shelves
- (1) 15" deep shelf
- (1) back stop
- (1) 16" high overhead cabinet with retractable door
- (1) 30" high louvered panel

PART NO.	DESCRIPTION
NXC/SM4825- <span style="color:red">■</span> <input type="checkbox"/>	surface-mount
NXC/RM4825- <span style="color:red">■</span> <input type="checkbox"/>	rear-mount for Align base

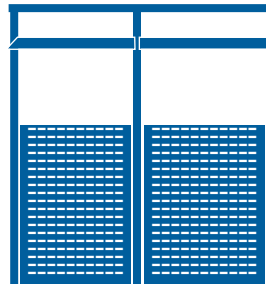

Includes:

- (2) 12" deep shelves
- (2) 30" high louvered panels

PART NO.	DESCRIPTION
NXC/SM4806- <span style="color:red">■</span> <input type="checkbox"/>	surface-mount
NXC/SM4816- <span style="color:red">■</span> <input type="checkbox"/>	surface-mount with 56" 4-bulb overhead light
NXC/RM4806- <span style="color:red">■</span> <input type="checkbox"/>	rear-mount for Align base
NXC/RM4816- <span style="color:red">■</span> <input type="checkbox"/>	rear-mount for Align base with 56" 4-bulb overhead light

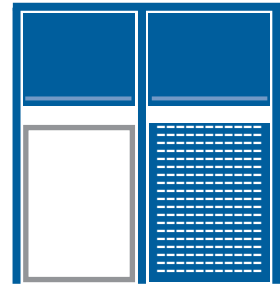

Includes:

- (2) 16" high overhead cabinets with retractable doors
- (1) 30" high markerboard/tackboard
- (1) 30" high louvered panel

PART NO.	DESCRIPTION
NXC/SM4828- <span style="color:red">■</span> <input type="checkbox"/>	surface-mount
NXC/RM4828- <span style="color:red">■</span> <input type="checkbox"/>	rear-mount for Align base

# Easy-Order Nexus System Packing Bench Combinations

The packing benches shown on the following two pages are pre-configured to include the most popular and versatile styles of packing benches we offer. To design a custom bench to suit your exact needs, see pages 88-89.

Easy-Order packing benches include technical panel legs, and are 33 1/2" high. Optional Nexus System packing bench combinations are 48" high.

## How to order an Easy-Order Packing Bench

1. **Select Easy-Order packing bench configuration.**
2. **Select worksurface style.**  
**LTS** = Lista Top  
**GLS** = Galvanized steel  
**BTS** = Butcher block  
 All worksurfaces have a standard square edge and are 30" deep.
3. **Select worksurface size.**  
**4830** = 48" long x 30" deep  
**6030** = 60" long x 30" deep  
**7230** = 72" long x 30" deep
4.  **Select paint color.** For color chart, see back cover.

## How to order an optional Easy-Order Nexus System Packing Bench Combination

1. **Select Easy-Order Nexus System configuration.**
2. **Select system length** (length must correspond to worksurface length as shown below).  
**42** = for 48" long worksurface  
**48** = for 60" long worksurface  
**60** = for 72" long worksurface
4.  **Select paint color.** For color chart, see back cover.

**EXAMPLE:** to order a PS6200 packing bench with a 72" long butcher block worksurface and a matching Nexus System combination with Bright Blue paint, the bench part number would be **PS6200-BTS7230BB**, and the Nexus System part number would be **NXC/SM48-PB01-60BB**.

## Single Bay Packing Benches

FRONT VIEW

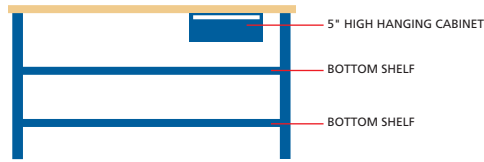

SIDE VIEW

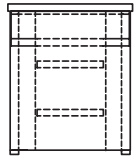

PART NO.	INCLUDES
PS6000- <input type="checkbox"/> <input type="checkbox"/> <input type="checkbox"/>	WBHC150-1 hanging cabinet

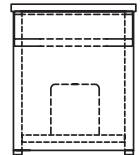
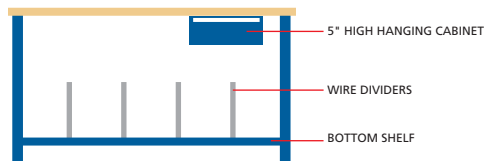

PART NO.	INCLUDES
PS6100- <input type="checkbox"/> <input type="checkbox"/> <input type="checkbox"/>	WBHC150-1 hanging cabinet

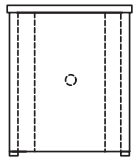
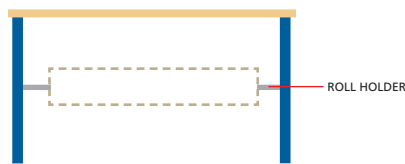

PART NO.	INCLUDES
PS6200- <input type="checkbox"/> <input type="checkbox"/> <input type="checkbox"/>	

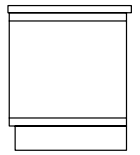
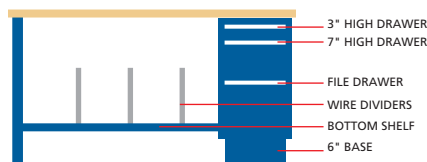

PART NO.	INCLUDES
PS6300- <input type="checkbox"/> <input type="checkbox"/> <input type="checkbox"/>	NW0600-0303N-F6RG cabinet

## Optional Nexus System Packing Bench Combination

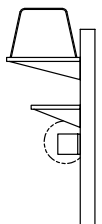
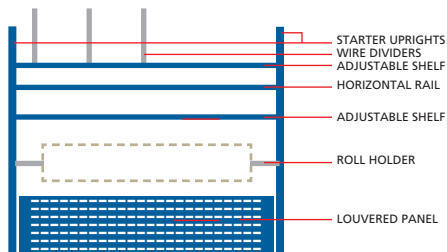

PART NO.	HEIGHT
NXC/SM48-PB01- <input type="checkbox"/> <input type="checkbox"/>	48"

## Long Packing Benches

FRONT VIEW

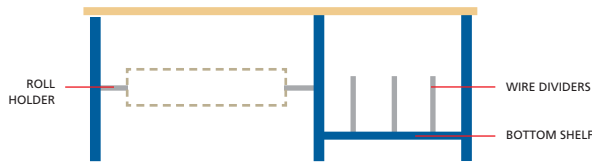

SIDE VIEW

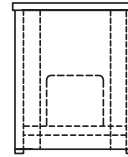

PART NO.	ROLL HOLDER LENGTH	BOTTOM SHELF LENGTH
PS6400- <input type="checkbox"/> <input type="checkbox"/>	72" top: 36" long; 84" & 96" top: 48" long	72" & 84" top: 24 1/4" long; 96" top: 36 1/4" long

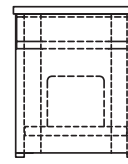

PART NO.	INCLUDES	BOTTOM SHELF LENGTH
PS6500- <input type="checkbox"/> <input type="checkbox"/>	WBHC150-1 hanging cabinet	all shelves are equal length

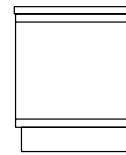

PART NO.	INCLUDES
PS6600- <input type="checkbox"/> <input type="checkbox"/>	NW0600-0303N-F6RG cabinet

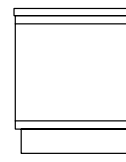
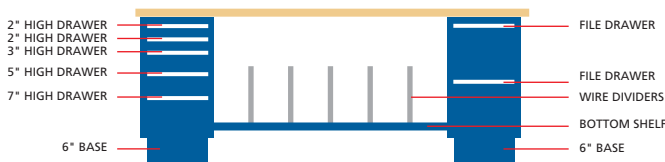

PART NO.	INCLUDES
PS6700- <input type="checkbox"/> <input type="checkbox"/>	NW0600-0501N-F6RG and NW0600-0201N-F6RG cabinets

## Optional Nexus System Packing Bench Combination

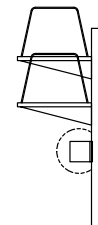
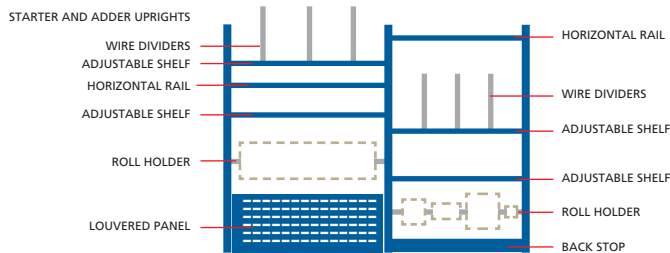

PART NO.	HEIGHT	STARTER SECTION WIDTH	ADDER SECTION WIDTHS
NXC/SM48-PB02- <input type="checkbox"/>	48"	42"	24" for 72" worksurface, 36" for 84" worksurface, 48" for 96" worksurface

### How to order a long Easy-Order Packing Bench

1. Select Easy-Order packing bench configuration.

2.  Select worksurface style.

**LTS** = Lista Top  
**GLS** = Galvanized steel  
**BTS** = Butcher block

All worksurfaces have a standard square edge and are 30" deep.

3.  Select worksurface size.

**7230** = 72" long x 30" deep  
**8430** = 84" long x 30" deep  
**9630** = 96" long x 30" deep

4.  Select paint color. For color chart, see back cover.

### How to order an optional Easy-Order Nexus System Packing Bench Combination

1. Select Easy-Order Nexus System configuration.

2.  Select system length (length must correspond to work surface length as shown below).

**66** = for 72" long worksurface  
**78** = for 84" long worksurface  
**90** = for 96" long worksurface

4.  Select paint color. For color chart, see back cover.

**EXAMPLE:** to order a PS6600 packing bench with an 84" long butcher block worksurface and a matching Nexus System combination with Bright Blue paint, the bench part number would be **PS6600-BTS8430BB**, and the Nexus System part number would be **NXC/SM48-PB02-78BB**.

Easy-Order stands (page 94) include leveling glides, and are 60", 72" or 84" high. Trolleys (page 95) include 2 swivel and 2 swivel with wheel locks 3 1/2" diameter casters (250 lb. capacity per caster), and a handle, and are either 48" or 60" high (plus height of casters). Stands and trolleys are 28" deep.

## How to order an Easy-Order Nexus Stand or Trolley

1. Select Easy-Order stand or trolley configuration.

2. ■ Select worksurface style for models NXF/FSR01, NXF/FSR02, NXF/FSR03 and NXF/FSR04.

**P2** = Plastic laminate  
**B2** = Butcher block

All worksurfaces have a bullnose front edge and are 24" deep.

3. ■ Select width.

**24** = 24" wide  
**30** = 30" wide  
**36** = 36" wide  
**42** = 42" wide  
**48** = 48" wide  
**60\*** = 60" wide

\*not available for models that include markerboard/tackboard

4. ■ Select height.

For stands:

**60** = 60" high  
**72** = 72" high  
**84** = 84" high

For trolleys:

**48** = 48" high  
**60** = 60" high

5.  Select paint color. For color chart, see back cover or below.

**EXAMPLE:** to order an NXF/FSR04 stand that is 36" wide and 60" high, with a butcher block worksurface and Bright Blue paint, the part number would be **NXF/FSR04B2-3660BB**.

### Front View Rear-justified

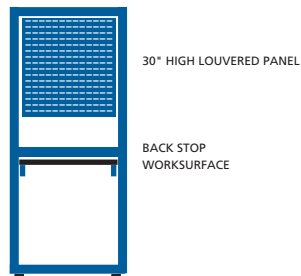

#### Workstand

PART NO.	DESCRIPTION
NXF/FSR01 <span style="color: red;">■</span> <span style="color: green;">■</span> <span style="color: blue;">■</span> <input type="checkbox"/>	starter
NXF/FSR01 <span style="color: red;">■</span> <span style="color: green;">■</span> <span style="color: blue;">■</span> <input type="checkbox"/> A	adder

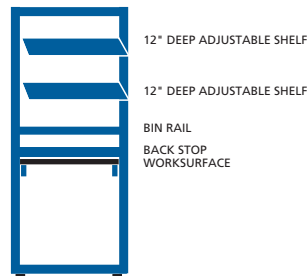

#### Workstand

PART NO.	DESCRIPTION
NXF/FSR02 <span style="color: red;">■</span> <span style="color: green;">■</span> <span style="color: blue;">■</span> <input type="checkbox"/>	starter
NXF/FSR02 <span style="color: red;">■</span> <span style="color: green;">■</span> <span style="color: blue;">■</span> <input type="checkbox"/> A	adder

### Side View Rear-justified

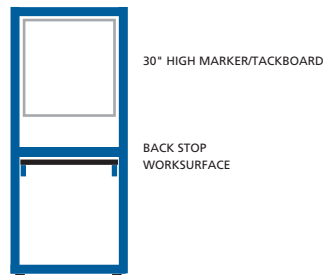

#### Workstand

PART NO.	DESCRIPTION
NXF/FSR03 <span style="color: red;">■</span> <span style="color: green;">■</span> <span style="color: blue;">■</span> <input type="checkbox"/>	starter
NXF/FSR03 <span style="color: red;">■</span> <span style="color: green;">■</span> <span style="color: blue;">■</span> <input type="checkbox"/> A	adder

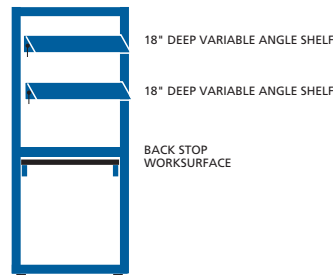

#### Workstand

PART NO.	DESCRIPTION
NXF/FSR04 <span style="color: red;">■</span> <span style="color: green;">■</span> <span style="color: blue;">■</span> <input type="checkbox"/>	starter
NXF/FSR04 <span style="color: red;">■</span> <span style="color: green;">■</span> <span style="color: blue;">■</span> <input type="checkbox"/> A	adder

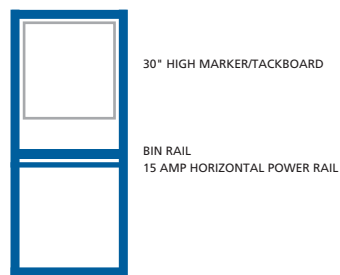

#### Companion Stand

PART NO.	DESCRIPTION
NXF/FSR05 <span style="color: green;">■</span> <span style="color: blue;">■</span> <input type="checkbox"/>	starter
NXF/FSR05 <span style="color: green;">■</span> <span style="color: blue;">■</span> <input type="checkbox"/> A	adder

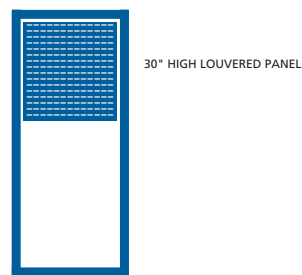

#### Companion Stand

PART NO.	DESCRIPTION
NXF/FSR06 <span style="color: green;">■</span> <span style="color: blue;">■</span> <input type="checkbox"/>	starter
NXF/FSR06 <span style="color: green;">■</span> <span style="color: blue;">■</span> <input type="checkbox"/>	adder



**Front View**  
Rear-justified

**Side View**  
Rear-justified

**Front View**  
Center-justified

**Side View**  
Center-justified

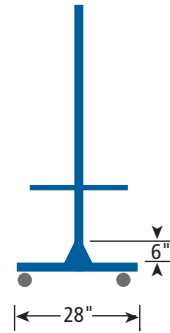
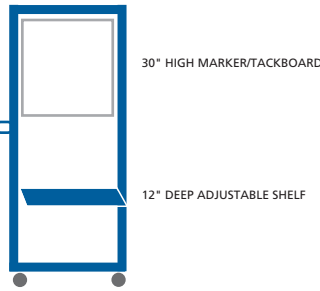
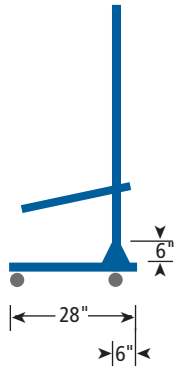
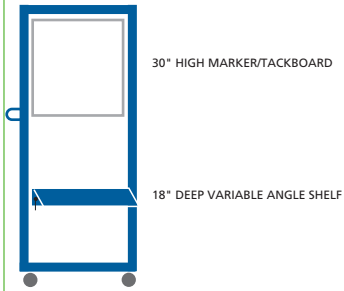

**Trolley**

PART NO.

NXF/MTR07-

**Trolley**

- Includes (2) 12" deep adjustable shelves

PART NO.

NXF/MTC08-

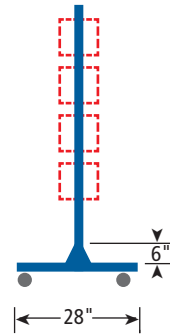
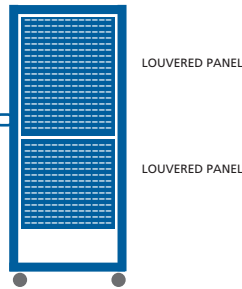
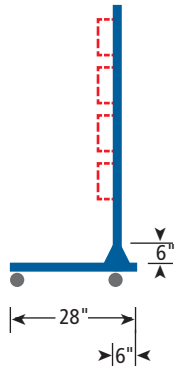
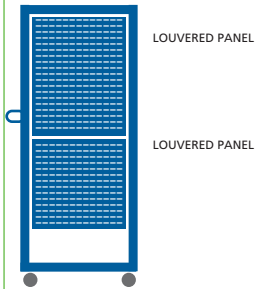

**Bin Trolley**

- 48" high trolley includes (1) 24" high and (1) 18" high louvered panels
- 60" high trolley includes (1) 30" high and (1) 24" high louvered panels

PART NO.

NXF/MTR09-

**Bin Trolley**

- 48" high trolley includes (2) 24" high and (2) 18" high louvered panels
- 60" high trolley includes (2) 30" high and (2) 24" high louvered panels

PART NO.

NXF/MTC10-

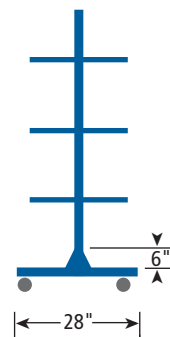
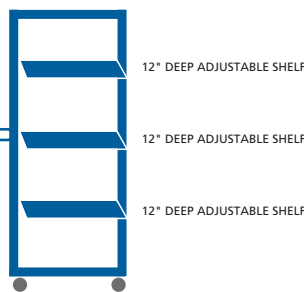
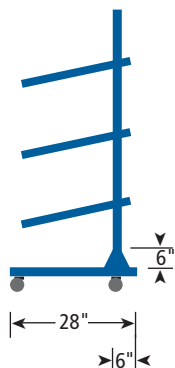
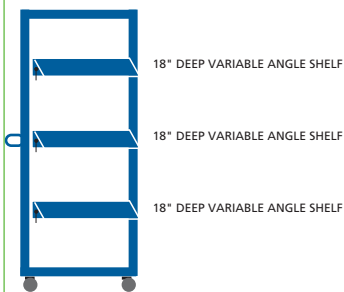

**Shelf Trolley**

PART NO.

NXF/MTR11-

**Shelf Trolley**

- Includes (6) 12" deep adjustable shelves

PART NO.

NXF/MTC12-